

P26

User Manual

V 1.0

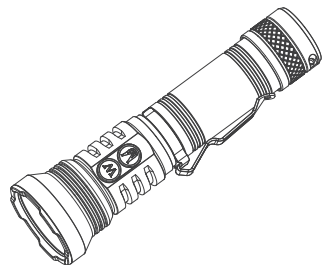

⚠ WARNINGS

- Please read user manual carefully before using the light.
- Product will generate heat while working, please be cautious with that to avoid any possible harm.
- Please don't shine into eyes directly to avoid harm to eyes.
- Please keep the light away from children.
- Please use WUBEN or WUBEN recommended batteries.
- Please don't disassemble the light or it will not be covered by WUBEN warranty policy.
- Please don't throw the product into fire.
- This is not a diving product, please don't use it underwater for a long time.

Product List

Before using this product, please check whether the contents of the package are complete.

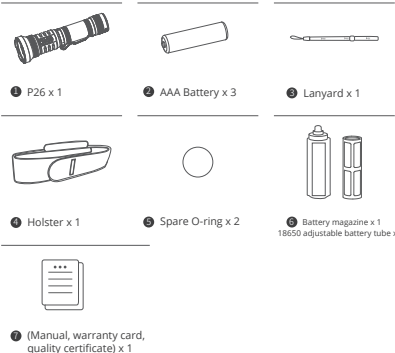

Product Features

P26 is a flashlight suitable for UV inspection. Utilized 1* CREE XPG3 LED and 1 pcs UV LED with a wavelength of 365nm, powered by 3*AAA batteries, compatible with 1*18650 Li-ion battery, it emits 500 lumens output. Design of the switches with battery status indication function makes the product more convenient to use.

Product Operation

1. Product Structure

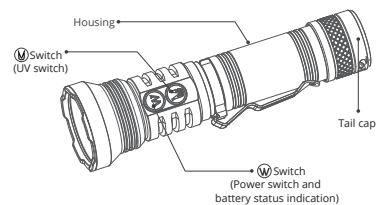

2. Installation

Please remove the insulation plate before using.

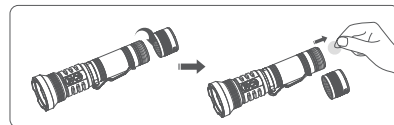

3. Operation

- 1 **White light mode ON/OFF:** Single click on switch to turn on or off the white light.
- 2 **Instant Turbo:** Whenever press and hold switch to activate Turbo mode, release to return to the previous status.
- 3 **UV light mode:** Single click on switch to turn on or off UV light.

4. Lockout and unlock

- 1 **Lockout:** When the light is off, triple click on switch, white light will blink three times to indicate the lockout.
- 2 **Unlock:** Triple click on switch, white light will blink three times to indicate the unlock.

5. Battery status indication

Power 100%~40%	Blue light constant on (Turn off after 5s)
Power 39%~30%	Blue light flashes (Turn off after 5s)
Power 29%~15%	Red light constant on (Turn off after 5s)
Power under 15%	Red light flashes

Parameters

Light color	White light		UV light
FL1 Standard	High	Low	/
	500LM	150LM	365nm/2W
	/	6.5h	5.5h
	150m		1.5m
	4200cd		IP68 (2m underwater for 1h)
Weight	117g/4.13oz (without battery) 145g/5.11oz (with battery)		
Dimension	130mm x 40mm 5.12in x 1.57in (L x D)		

⚠ All data from experiments of WUBEN lab, may vary because of different experiment equipment, experiment environment or other factors.

Optional accessories

WUBEN ABE2600C battery,
WUBEN ABE3100C battery,
WUBEN ABE3400 battery.

FAQs

Problems	Causes	Solutions
Abnormal flash or failure to turn on	Check if the flashlight is lockout	Triple click on the switch
	Check if the switch is turned on correctly	Turn on the switch
	Check if it is assembled in place	Tighten the assembly parts
	Check if the battery is no power	Use the charger to check the battery
	Check if the battery is reversed	Remove the battery and reassemble it correctly
Abnormal noise	Check if the conductive position is dirty	Clean the surface with alcohol
	Check if foreign matter falls in the tube	Pour out possible foreign matter
	Part damage	Return the light to local distributor

If your problems still not solved yet, please contact seller for after-sales service.

Maintenance

- The O-Ring may be damaged for a long time use, please replace the O-Ring in time to ensure the waterproofness of the product.
- Please use WUBEN battery or WUBEN recommended batteries.

- When the flashlight indicates low power, please charge or replace the battery in time to avoid affecting the durability of the battery.
- Please use alcohol and rag to clean the conductive parts of the flashlight in time.
- When not in use for a long time, please remove the battery to prevent the battery from leaking or exploding, store the flashlight in a dry and ventilated place.

Warranty policy

1. Warranty coverage

- **15 days replacement:** Within 15 days from the date of purchase, if the product has quality problems, customers can request free replacement.
- **1 year warranty:** Within 1 year from the date of purchase, if the product has quality problems, WUBEN will offer free repair.
- **5 years warranty:** Within 5 years from the date of purchase, if the product (accessories excluded) has quality problems, WUBEN will offer free repair for WUBEN registered customers.
- **Lifetime maintenance:** From the date of purchase, if the product has problem after 5 years, WUBEN will offer paid repair for WUBEN registered customers.
- If proof of purchase cannot be provided, it will be counted on the date of manufacture.
- If there is any dispute, the two parties will coordinate to solve.

2. Beyond warranty

- Man-made damage.
- Damage caused by not following the instructions.
- Damage caused by improper use of the battery.
- Abnormal wear and tear.
- Damage caused by irresistible factors.
- Gifts.

The final interpretation right is reserved by WUBEN.