

SUPER HEAVY DUTY BATTERY

4R25X

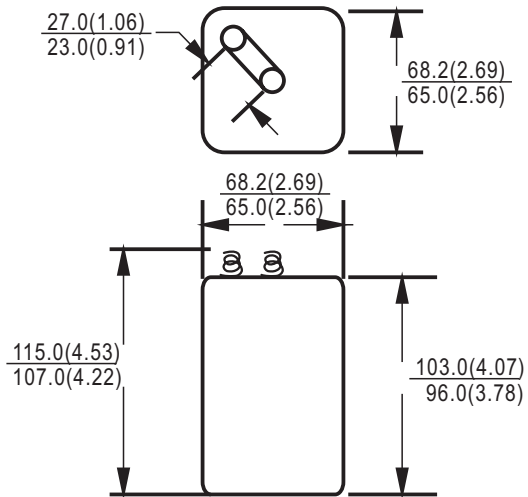

Unit: mm(inch)

Chemical System : Zinc /Manganese Dioxide
(Zinc Chloride Electrolyte)

Camelion No : 4R25X

IEC No. : 4R25X

ANSI/NEDA No.: 908CD

Average Weight : 500.0g

Dimension (Lx W x H) : 65.0x65.0x96.0 mm

Terminals: Spring

Nominal Voltage : 6.0Volts

Operating Temperature: -30°C ~55°C

Average Capacity : 7000 mAh to 3.2 volts
(20±2°C, Rated capacity at 25 mA continuous drain)

Shell: Plastic

Label : Paper Label

Discharge Characteristic

Load Resistance (Ω)	End Point Voltage (V)	Discharge Pattern	Duration
8.2	3.60	30min/day	400min
9.1	3.60	30min/h,8h/day	370min
15.6	3.60	24h/day	700min
110	3.60	12h/day	155hrs

Discharge curves

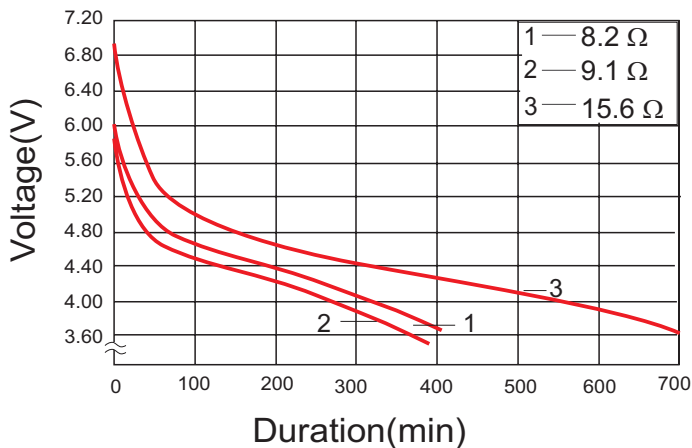

Discharge curve

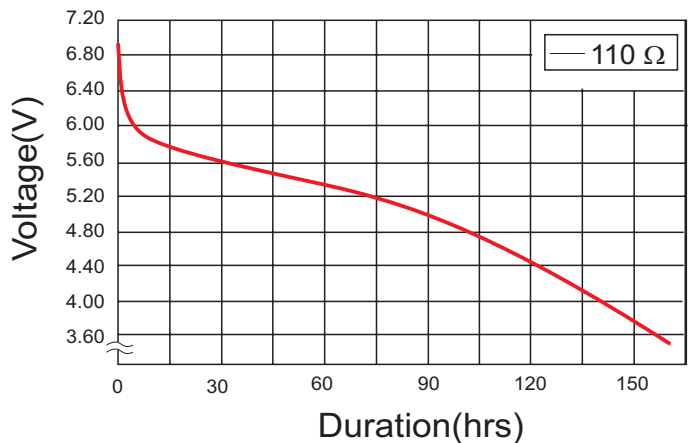

Notice:

Environmental elements comply with RoHS requirements. This information is subject to change without prior notice and for reference only. It should not be used as a basis for a product guarantee or warranty. For additional information, please consult your nearest Camelion Sales Office or Distributor or visit our website at: www.camelionbattery.com.